

RX87

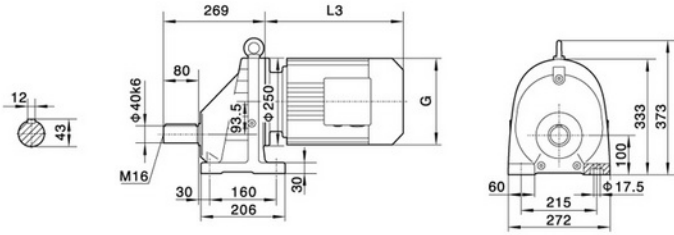

RX..S87

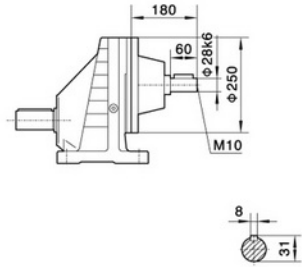

RXF87

Φ250

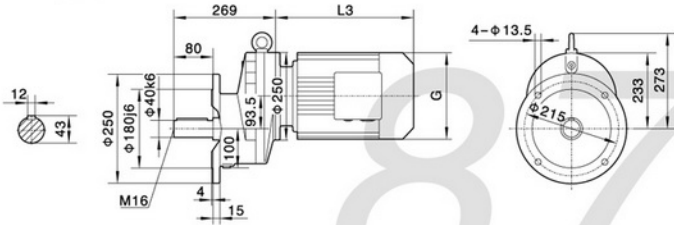

电机需方配时或配特殊电机时需加联接法兰
 When equipping the user's motor or the special one, the flange is required to be connected.

R

Φ300

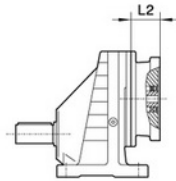
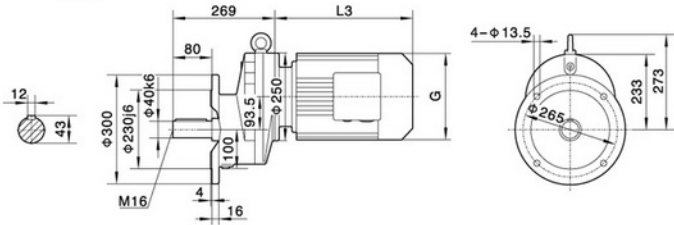

注：其余尺寸见相应的结构形式
 Note: For other values please refer to the oppsited structure

Y ₂ 电机座号 Motor size	100	112M	132S	132M	160M	160L	180M	180L	
功率/4P Power/(kW)	3.0	4.0	5.5	7.5	11	15	18.5	22	
L3	351	380	425	461	524	547	583	616	
G	215	240	275	275	330	330	380	380	
L2	71	71	101	101	126	126	126	126	

注：“RX..”表示RX、RFX
 Note：“RX..”mean RX、RFX

RX97

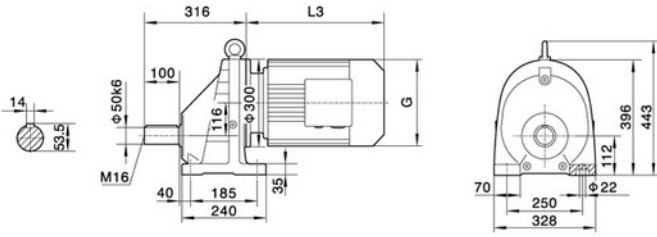

RX..S97

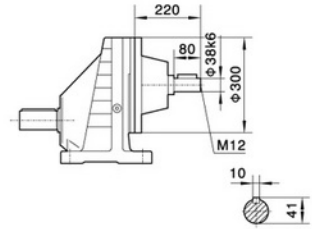

RXF97

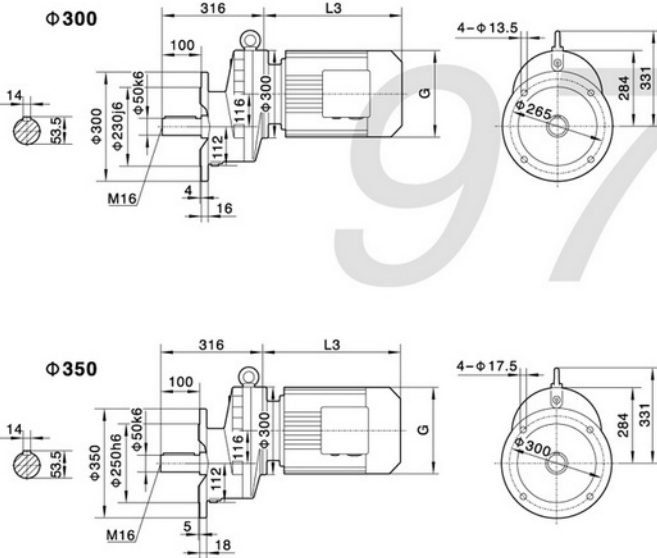

电机需方配时或配特殊电机时需加联接法兰
When equipping the user's motor or the special one, the flange is required to be connected.

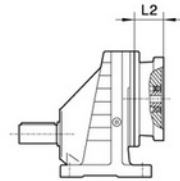

注：其余尺寸见相应的结构形式
Note: For other values please refer to the opposite structure

Y ₂ 电机机座号 Motor size 功率(kW)	132S	132M	160M	160L	180M	180L	200
L3	425	461	524	547	555	588	654
G	275	275	330	330	380	380	420
L2	101	101	126	126	126	126	126

注：“RX..”表示RX、RFX
Note：“RX..”mean RX、RFX

RX107

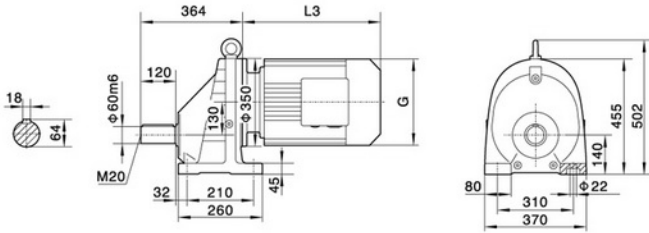

RX..S107

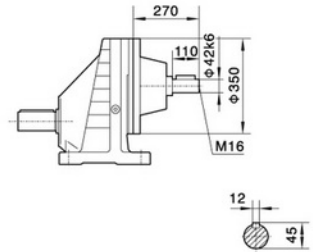

RXF107

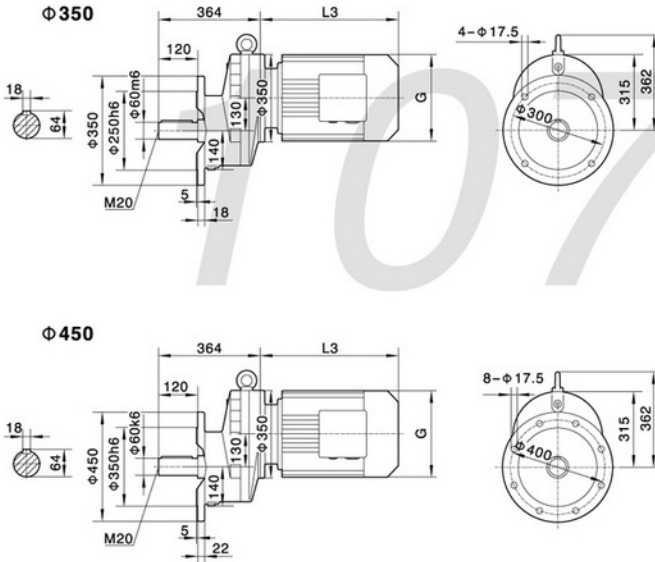

电机需方配时或配特殊电机时需加联接法兰
 When equipping the user's motor or the special one, the flange is required to be connected.

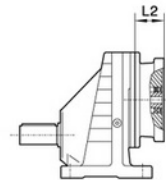

注：其余尺寸见相应的结构形式
 Note: For other values please refer to the oppsited structure

Y ₂ 电机座号 Motor size	132M	160M	160L	180M	180L	200	225S	225M	
功率/kW Power(kW)	7.5	11	15	18.5	22	30	37	45	
L3	422	504	519	555	588	654	680	702	
G	275	330	330	380	380	420	470	470	
L2	101	126	126	126	126	132	132	132	

注：“RX..”表示RX、RFX
 Note:“RX..”mean RX、RFX

R17

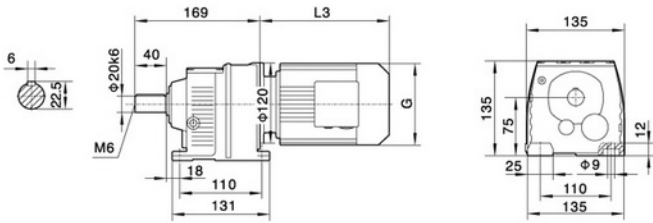

电机需方配时或配特殊电机时需加联接法兰
 When equipping the user's motor or the special one, the flange is required to be connected.

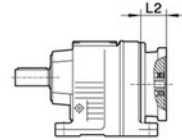

注：其余尺寸见相应的结构形式
 Note: For other values please refer to the opposite structure

RF17

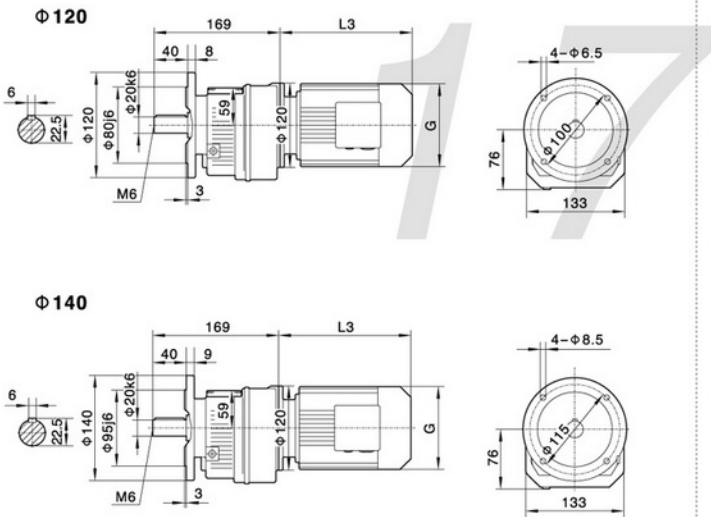

Y2电机机座号 Motor size	63	71	80						
功率/4P Power/(kW)	0.18	0.25 0.37	0.55 0.75						
L3	235	245	278						
G	130	145	175						
L2	71	71	71						

注：“R..”表示R、RF
 Note:“R..”mean R、RF

R

R27

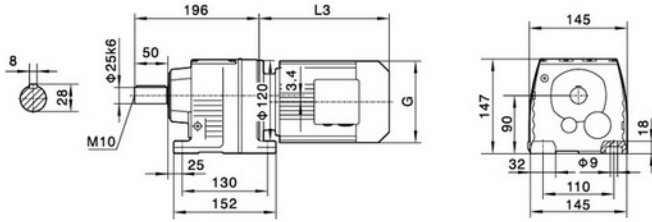

电机需方配时或配特殊电机时需加联接法兰
When equipping the user's motor or the special one, the flange is required to be connected.

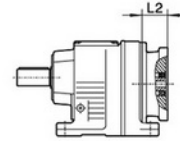

RF27

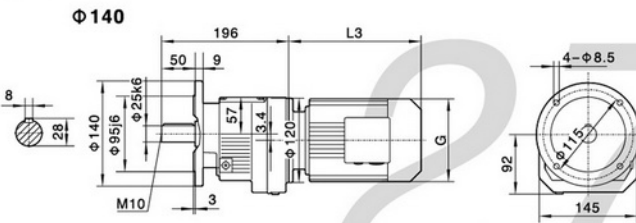

R..S27

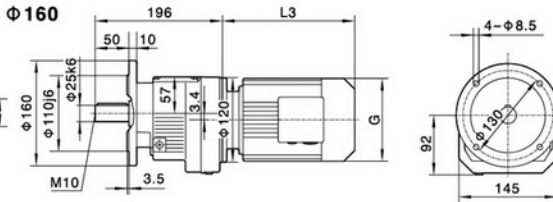
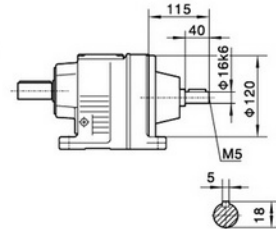

R..27R17

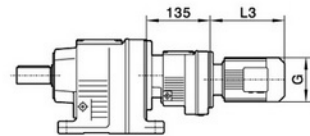

注：其余尺寸见相应的结构形式
Note: For other values please refer to the opposite structure

Y ₂ 电机机座号 Motor size	63	71	80	90S	90L	100	
功率/4P Power/(kW)	0.18	0.25 0.37	0.55 0.75	1.1	1.5	2.2 3.0	
L3	235	245	278	304	328	340	
G	130	145	175	195	195	215	
L2	71	71	71	71	71	93	

注：“R..”表示R、RF

Note：“R..”mean R、RF

R37

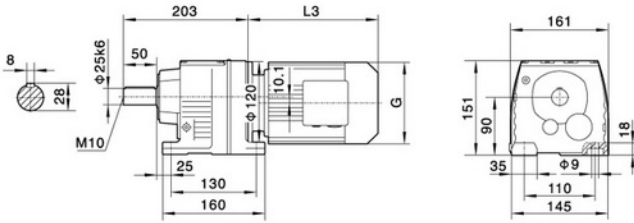

电机需方配时或配特殊电机时需加联接法兰
 When equipping the user's motor or the special one, the flange is required to be connected.

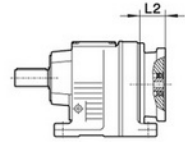

RF37

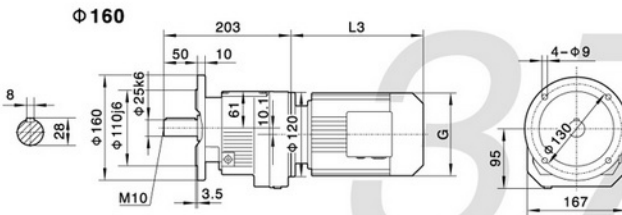

R..S37

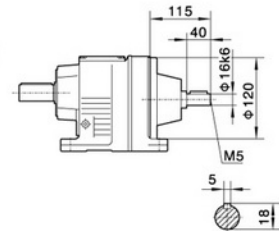

R

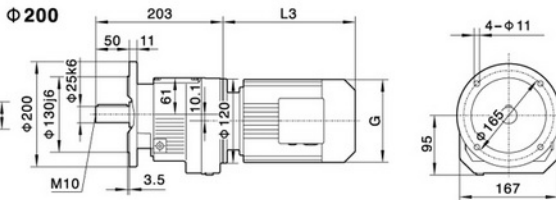

R..37R17

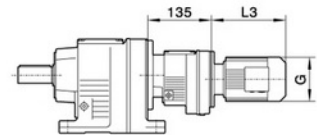

注：其余尺寸见相应的结构形式
 Note: For other values please refer to the opposite structure

Y ₂ 电机机座号 Motor size	63	71	80	90S	90L	100L		
功率/4P Power/(kW)	0.18	0.25 0.37	0.55 0.75	1.1	1.5	2.2 3.0		
L3	235	245	278	304	328	340		
G	130	145	175	195	195	215		
L2	71	71	71	71	71	93		

注：“R..”表示R、RF Note：“R..”mean R、RF

R47

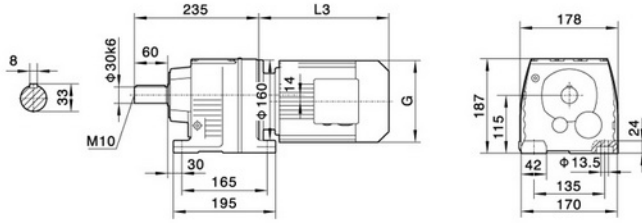

电机需方配时或配特殊电机时需加联接法兰
When equipping the user's motor or the special one, the flange is required to be connected.

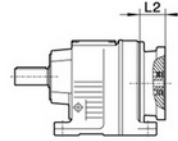

RF47

Φ 160

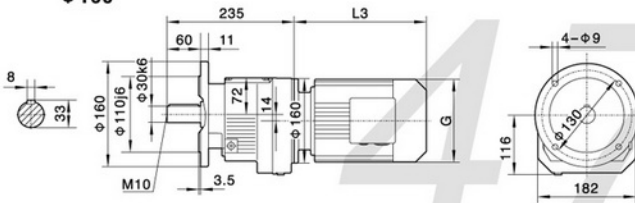

R..S47

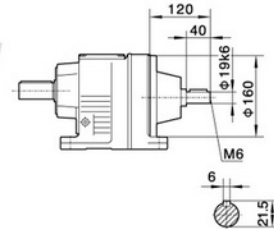

Φ 200

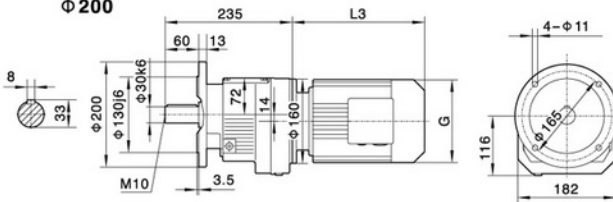

R..47R37

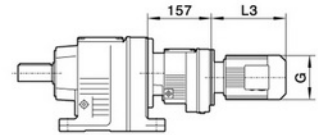

注：其余尺寸见相应的结构形式
Note: For other values please refer to the opposite structure

Y ₂ 电机机座号 Motor size	63	71		80		90S	90L	100		112M	132S	
功率/4P Power/(kW)	0.18	0.25	0.37	0.55	0.75	1.1	1.5	2.2	3.0	4.0	5.5	
L3	223	245		278		304	328	350		380	425	
G	130	145		175		195	195	215		240	275	
L2	81	81		81		81	81	93		93	101	

注：“R..”表示R、RF

Note：“R..”mean R、RF

R57

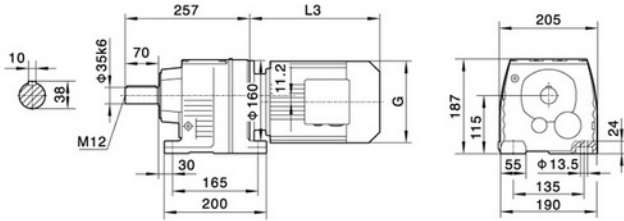

电机需方配时或配特殊电机时需加联接法兰
 When equipping the user's motor or the special one, the flange is required to be connected.

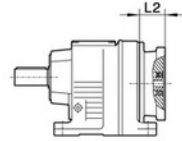

RF57

Φ 200

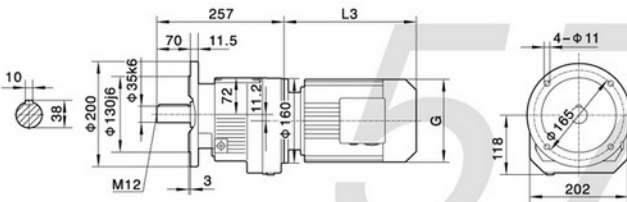

R..S57

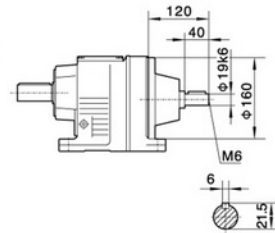

Φ 250

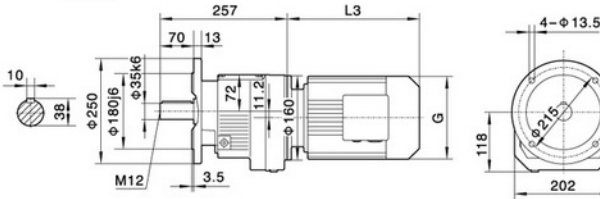

R..57R37

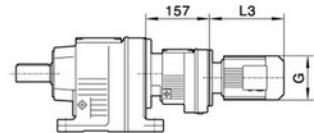

注：其余尺寸见相应的结构形式
 Note: For other values please refer to the oppsited structure

Y ₂ 电机机座号 Motor size	63	71	80	90S	90L	100L	112M	132S	132M	
功率/4P Power/(kW)	0.18	0.25 0.37	0.55 0.75	1.1	1.5	2.2 3.0	4.0	5.5	7.5	
L3	223	245	278	304	328	350	380	425	461	
G	130	145	175	195	195	215	240	275	275	
L2	81	81	81	81	81	93	93	101	101	

注：“R..”表示R、RF

Note：“R..”mean R、RF

R

R67

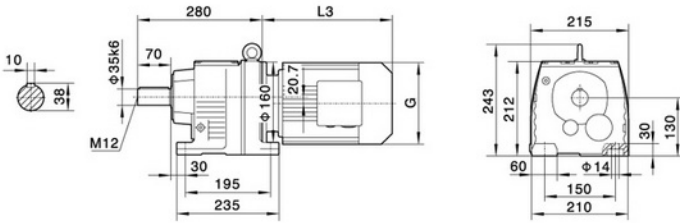

电机需方配时或配特殊电机时需加联接法兰
When equipping the user's motor or the special one, the flange is required to be connected.

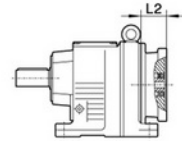

RF67

Φ200

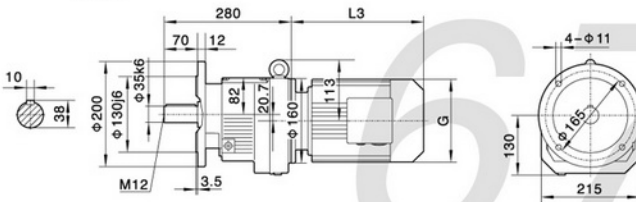

R..S67

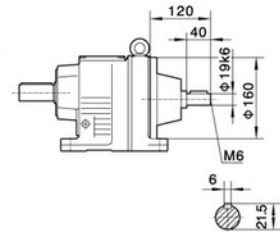

Φ250

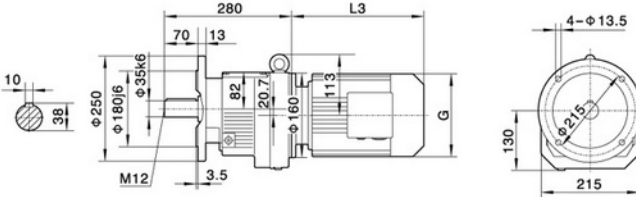

R..67R37

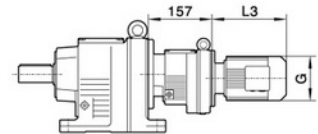

注：其余尺寸见相应的结构形式
Note: For other values please refer to the opposite structure

Y ₂ 电机机座号 Motor size	63	71	80	90S	90L	100L	112M	132S	132M	
功率/4P Power/(kW)	0.18	0.25 0.37	0.55 0.75	1.1	1.5	2.2 3.0	4.0	5.5	7.5	
L3	223	245	278	304	328	350	380	425	461	
G	130	145	175	195	195	215	240	275	275	
L2	81	81	81	81	81	93	93	101	101	

注：“R..”表示R、RF

Note：“R..”mean R、RF

R77

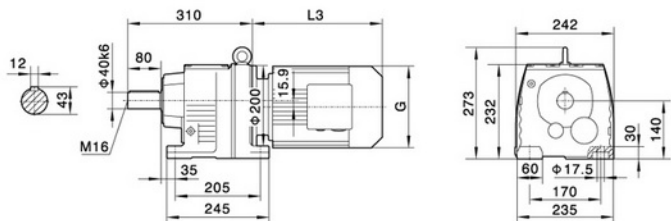

电机需方配时或配特殊电机时需加联接法兰
 When equipping the user's motor or the special one, the flange is required to be connected.

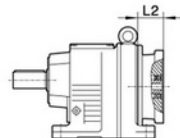

RF77

Φ 250

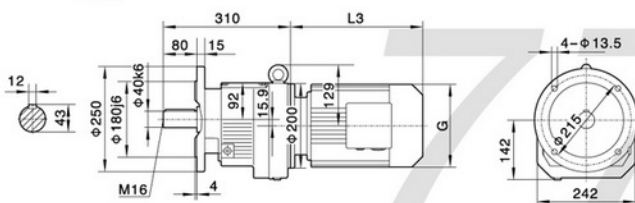

R..S77

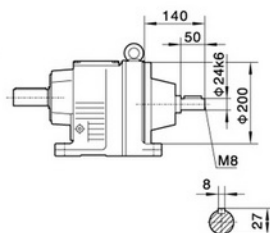

Φ 300

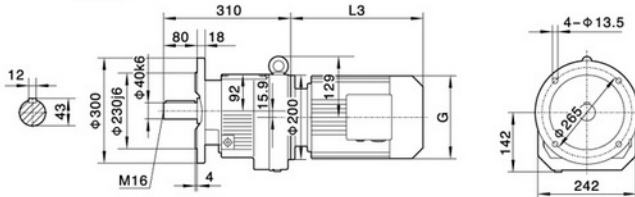

R..77R37

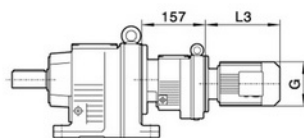

注：其余尺寸见相应的结构形式
 Note: For other values please refer to the oppsited structure

Y ₂ 电机机座号 Motor size	63	71	80	90S	90L	100L	112M	132S	132M	160M
功率/4P Power/(kW)	0.18	0.25 0.37	0.55 0.75	1.1	1.5	2.2 3.0	4.0	5.5	7.5	11
L3	223	233	278	304	328	350	380	425	461	524
G	130	145	175	195	195	215	240	275	275	330
L2	81	81	81	81	81	93	93	101	101	126

注：“R..”表示R、RF

Note：“R..”mean R、RF

R

R87

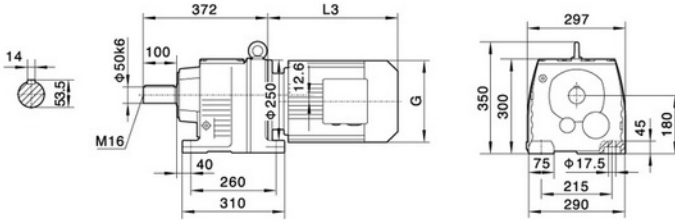

电机需方配时或配特殊电机时需加联接法兰
When equipping the user's motor or the special one, the flange is required to be connected.

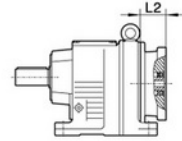

RF87

Φ 300

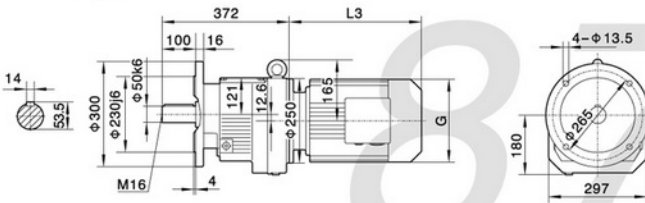

R..S87

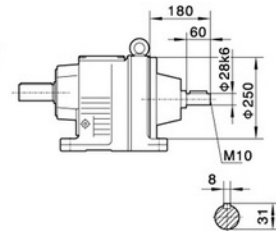

Φ 350

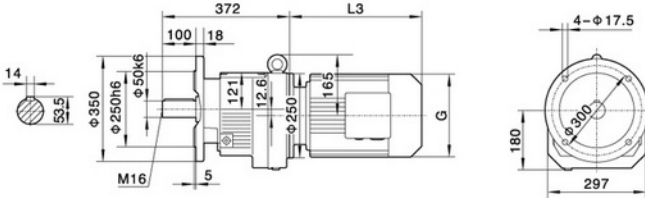

R..87R57

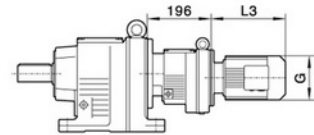

注：其余尺寸见相应的结构形式
Note: For other values please refer to the oppsited structure

Y ₂ 电机机座号 Motor size	80	90S	90L	100	112M	132S	132M	160M	160L	180M	180L
功率/4P Power/(kW)	0.55	0.75	1.1	1.5	2.2	3.0	4.0	5.5	7.5	11	15
L3	246	280	304	350	380	425	461	524	547	583	616
G	175	195	195	215	240	275	275	330	330	380	380
L2	86	86	86	71	71	101	101	126	126	126	126

注：“R..”表示R、RF

Note:“R..”mean R、RF

R97

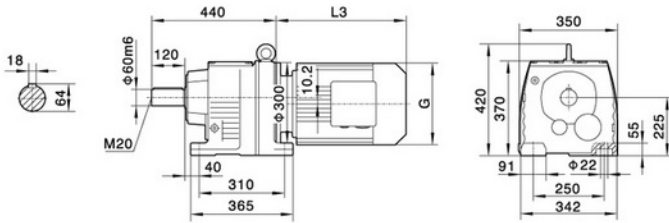

电机需方配时或配特殊电机时需加联接法兰
 When equipping the user's motor or the special one, the flange is required to be connected.

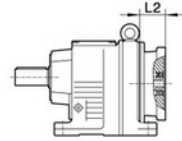

RF97

Φ 350

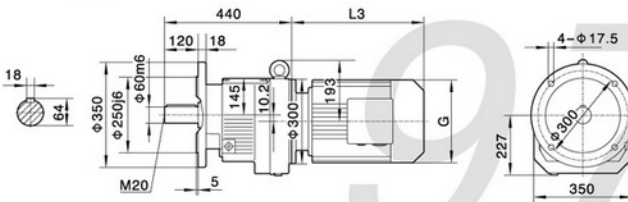

R..S97

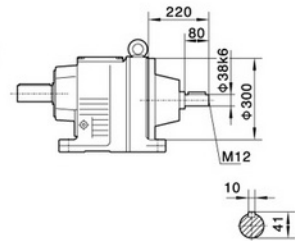

Φ 450

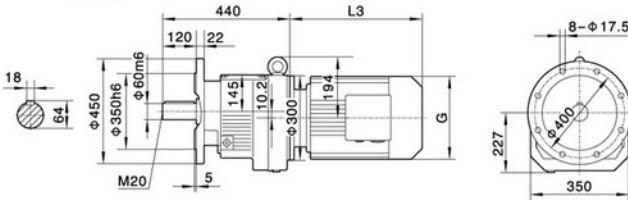

R..97R57

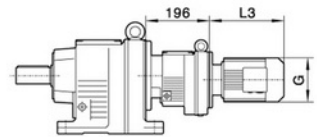

注：其余尺寸见相应的结构形式
 Note: For other values please refer to the opposite structure

Y ₂ 电机机座号 Motor size 功率/4P Power/(kW)	80	90S	90L	100	112M	132S	132M	160M	160L	180M	180L	200	
L3	246	280	304	315	334	425	461	524	547	555	588	654	
G	175	195	195	215	240	275	275	330	330	380	380	420	
L2	86	86	86	101	101	101	101	126	126	126	126	132	

注：“R..”表示R、RF

Note：“R..”mean R、RF

R



RED SUN

外形安装尺寸
Mounting Dimension Sheets-overview

由 Foxit PDF Editor 编辑
版权所有 (c) by Foxit 公司, 2003 - 2010
仅用于评估。

R107

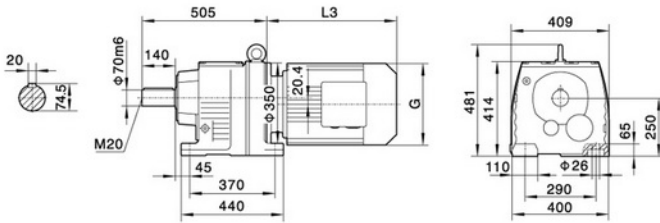

电机需方配时或配特殊电机时需加联接法兰
When equipping the user's motor or the special one, the flange is required to be connected.

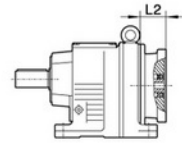

RF107

Φ 350

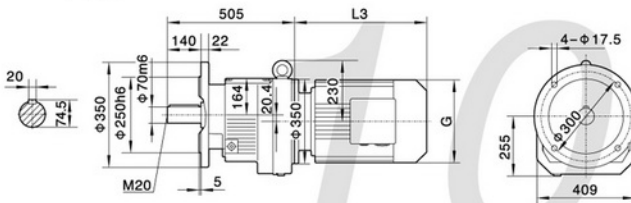

R..S107

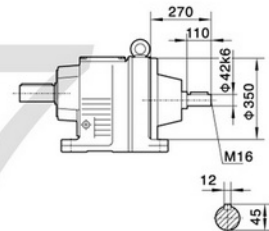

Φ 450

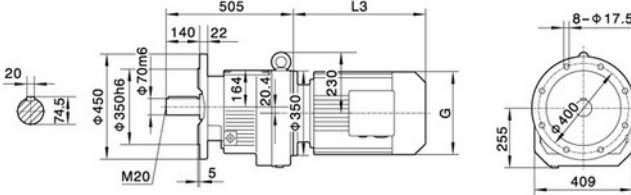

R..107R77

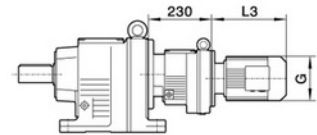

注：其余尺寸见相应的结构形式
Note: For other values please refer to the opposite structure

Y ₂ 电机机座号 Motor size	100	112M	132S	132M	160M	160L	180M	180L	200	225S	225M	
功率/4P Power/(kW)	2.2 3.0	4.0	5.5	7.5	11	15	18.5	22	30	37	45	
L3	318	334	386	422	504	519	555	588	654	680	702	
G	215	240	275	275	330	330	380	380	420	470	470	
L2	101	101	101	101	126	126	126	126	132	132	132	

注：“R..”表示R、RF

Note:“R..”mean R、RF

R137

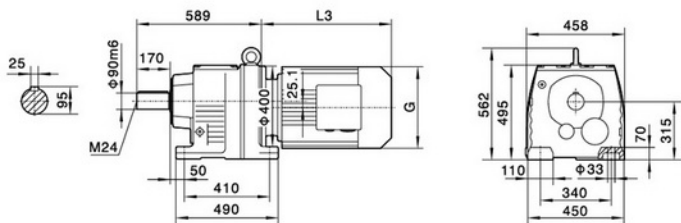

电机需方配时或配特殊电机时需加联接法兰
 When equipping the user's motor or the special one, the flange is required to be connected.

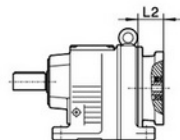

RF137

Φ450

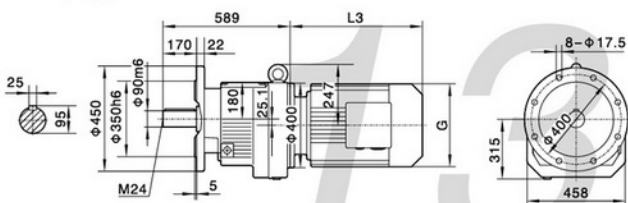

R..S137

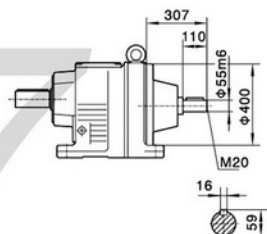

Φ550

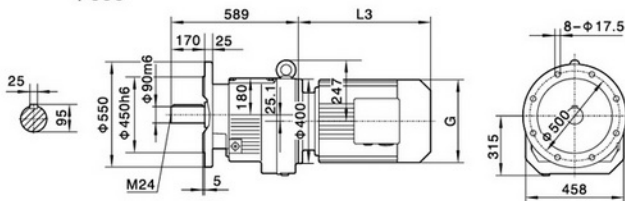

R..137R77

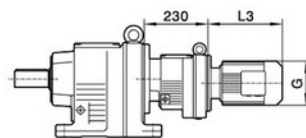

注：其余尺寸见相应的结构形式
 Note: For other values please refer to the oppsited structure

Y ₂ 电机机座号 Motor size	132S	132M	160M	160L	180M	180L	200	225S	225M	250
功率/4P Power/(kW)	5.5	7.5	11	15	18.5	22	30	37	45	55
L3	388	424	476	519	555	588	654	680	702	771
G	275	275	330	330	380	380	420	470	470	510
L2	126	126	132	132	132	132	132	143	143	174

注：“R..”表示R、RF

Note：“R..”mean R、RF

R147

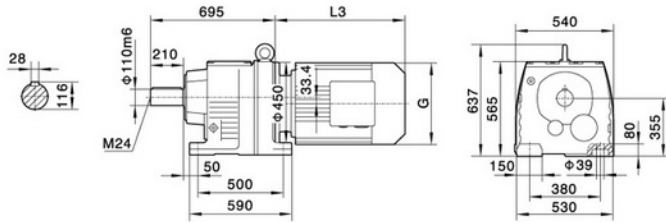

电机需方配时或配特殊电机时需加联接法兰
When equipping the user's motor or the special one, the flange is required to be connected.

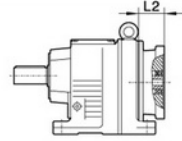

RF147

Φ 450

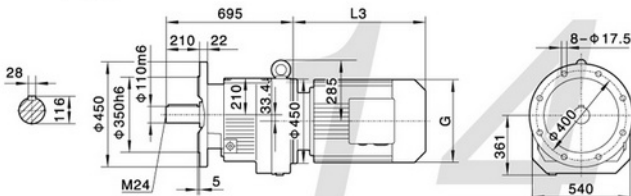

R..S147

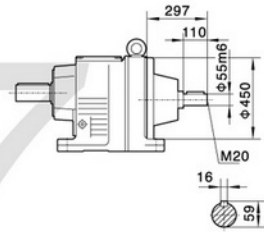

Φ 550

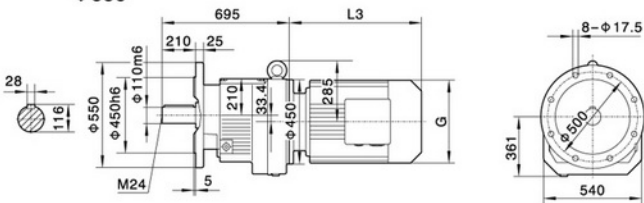

R..147R87(R77)

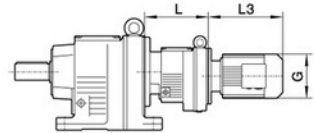

	R..147R77组合	R..147R87组合
L	226	275

注：其余尺寸见相应的结构形式
Note: For other values please refer to the oppsited structure

Y ₂ 电机机座号 Motor size	160M	160L	180M	180L	200	225S	225M	250	280S	280M
功率/4P Power/(kW)	11	15	18.5	22	30	37	45	55	75	90
L3	567	602	583	616	654	674	696	775	845	845
G	330	330	380	380	420	470	470	510	580	580
L2	132	132	132	132	132	143	143	174	174	174

注：“R..”表示R、RF Note:“R..”mean R、RF

R167

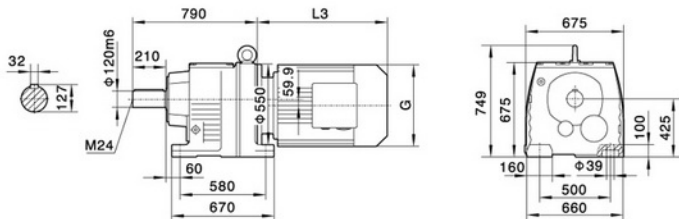

电机需方配时或配特殊电机时需加联接法兰
 When equipping the user's motor or the special one, the flange is required to be connected.

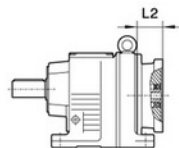

RF167

φ550

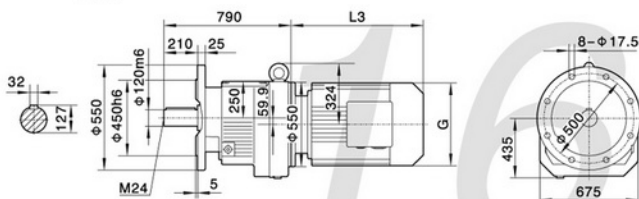

R..S167

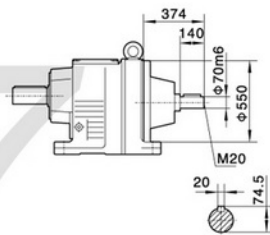

φ660

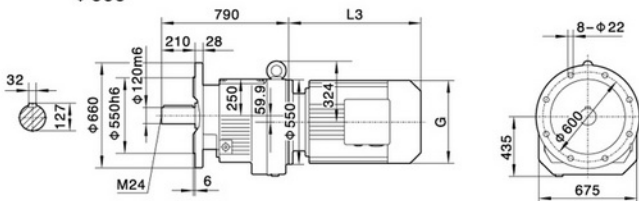

R..167R97(R107)

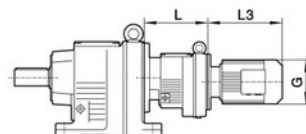

	R..167R97组合	R..167R107组合
L	320	370

注：其余尺寸见相应的结构形式
 Note: For other values please refer to the oppsited structure

Y ₂ 电机机座号 Motor size 功率/4P Power/(kW)	160M	160L	180M	180L	200	225S	225M	250	280S	280M	315S	315M	315L
L3	567	602	635	666	642	669	691	770	828	879	1100	1130	1360
G	330	330	380	380	420	470	470	510	580	580	645	645	645
L2	143	143	143	143	143	143	143	113	113	113	113	145	145

注：“R..”表示R、RF

Note：“R..”mean R、RF